

SpanSet®

03

Fall Protection
Lifting
Cargo Control
Safety Management





SpanSet is here for you:
Switzerland, Australia, Austria, Brazil, China,
France, Germany, Hungary, UK, Indonesia, Italy,
Poland, Spain, Taiwan, USA

Contents

Quality and Service	4
03.1 Ratchet Strap Assemblies	6-13
2" Ratchet Assemblies	10-12
2" ABS™ Controlled Release Ratchet Tiedown System	12
3" & 4" Ratchet Assemblies, Extra Heavy Duty	12-13
03.2 Winch Strap Assemblies	14-19
LoadGard™ and WearGard™ Winch Strap Assemblies	16
Trailer Winches	18
Heavy Duty Trailer Winches	18
Spool Type Weld on Webbing Winches	18
Winch Bars & Accessories	19
Web Strap Winder	19
Weld-On Slider Winch Track	19
Winch Bars	19
03.3 Accessories	20-25
Internal Load Control Products	22
Internal Van Straps	22
Rope Tie-off	22
SpanLoc™ Cargo Bars	23
Logistics Track-Series E	23
Decking Shoring Beams	23
Wood Beam Socket	23
Door Pull Strap	23
Automobile Tiedowns	24
Interior Van Custom Nets	24
Chain Binders	25
Tarp Straps	25
Corner Protectors	25
Stake Pocket Anchors	25
03.4 Utility Tiedowns	26-30
1" Ratchet Buckle Assemblies	28
1 3/8" Ratchet Buckle Assemblies	29
2" Ratchet Buckle Assemblies	29
1" Cam Buckle Assemblies	29
Tow Straps	30
Heavy Duty Recovery Tow Straps	30
Other Products	31

SpanSet Incorporated is part of the international SpanSet Group which has manufacturing sites and licensees worldwide.

As a recognized industry leader, SpanSet has directed its business with the understanding that success is guided by customer satisfaction. If we are to grow and prosper we fully understand that we must continue to offer good quality merchandise, dependable service, qualified technical support, and competitive pricing. SpanSet, Inc. is committed to these principals.

With over 30 years of experience and acquired know-how in manufacturing and in solving load securement problems, SpanSet is being specified as the preferred supplier in a wide variety of applications. In addition to standard stocking catalog items, SpanSet offers specialized and custom designed products to meet specific requirements. Further details are available on request from our sales office.

SpanSet's policy of continuous commitment to development may require the product range to be modified. We therefore, reserve the right to make changes to the products and specifications in this catalog without prior notice.

Quality Control

From incoming raw materials and component parts to final assembly, SpanSet products are subjected to strict ANSI/ASQC and ISO 9001:2000 standards for quality control and assurance. Metal parts are manufactured from high quality steels and alloys with equally rigid standards for plated, epoxy coated or painted finishes.

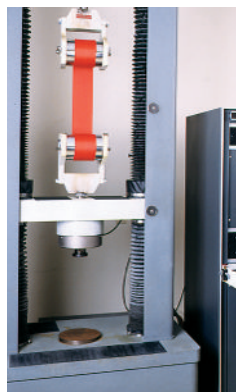

SpanSet, Inc. is an ANSI/ASQC and ISO 9001:2008 registered company. This certification attests that its quality system meets internationally accepted standards for quality assurance in its management and manufacturing practices. All SpanSet webbing meets the requirements of OSHA and are manufactured in accordance with ASME B30.9 and WSTDA industry standards.

Weaving

The webbing used in SpanSet's textile products is manufactured in-house on state-of-the-art high speed weaving looms. Yarns of either nylon or polyester are of the highest quality for greater strength, durability, and controlled elasticity.



Quality and Service. Our Commitment to You.

Sewing

Electronically controlled sewing machines ensure the highest standards of quality, consistency, and reliability of the load bearing seams on the heavy duty tiedowns, utility rated tiedowns, and flat web slings. Rigorous manufacturing and sewing standards are maintained for the forming of eyes and the attachment of ratchet buckles, hooks, and other components.



Finishing

The loom state greige webbing is carefully dyed and thermo-fixed giving greater abrasion resistance, protection from deterioration from the sun's ultraviolet rays, and reduced elongation. An optional PVC coating offers exceptional resistance to abrasion and cutting in the aggressive environments to which the products will be subjected. The finished webbing is rolled in specific lengths or boxed in bulk.



03.1





Ratchet Strap Assemblies

LoadGard™

2" Ratchet Assemblies with Long Wide handles

3" Ratchet Assemblies - Extra Heavy Duty

4" Ratchet Assemblies - Extra Heavy Duty

WearGard™

2" Ratchet Assemblies with Long Wide handles

3" Ratchet Assemblies - Extra Heavy Duty

4" Ratchet Assemblies - Extra Heavy Duty



Medium and Light Duty Ratchets

tension gently, secure efficiently

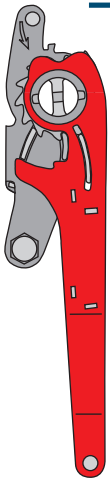

For securing heavy loads in day to day business, you not only need cargo control that you can rely on, you also need a solution that makes your work easier.

Longer handle, tensioning that protects your back

The extended handle of the Ergo ratchet makes lashing much easier. You can achieve even high pre-tensioning forces using much less muscle power. Ergo ratchets pull downwards instead of pushing upwards making them much easier on your back.

With the extra long lever, you'll be able to bring safety demands to an even higher level.

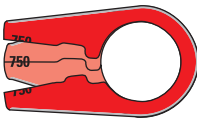

Tension Force Indicator

With the patented TFI, you can verify the pre-tension force in the system quickly and easily. When the jaws of the TFI are closed, it indicates the maximum pre-tensioning force that can be achieved of 750daN. Intermediate stages can also be read off. It just can't get any easier. And now there is also a TFI with an adapter for the adjustable end.

Our tension force indicator helps prevent over tensioning and ensures the correct tension is applied every time it is used. Contact our customer service department about adding your tension force indicator today!

Optional integrated edge protection

Straps by SpanSet are available with a low elasticity of max 4%. Thanks to the additional wear resistant selvage, selvage, they won't wear away. Even on rough loads, meaning you have a tough partner on your side to achieve load security.

"Anti-Belt-Slip" procedure

The ratchet is opened, the tension loosens sporadically, and the load gets out of control: Anyone who has experienced this knows how important ABS is. It means you have complete control even during release. The ABS system allows you to release the pre-tension force in small steps. This gives you the opportunity to use a fork-lift truck to straighten up any loads that threaten to tip and are leaning into the strap, helping to prevent damage and accidents.

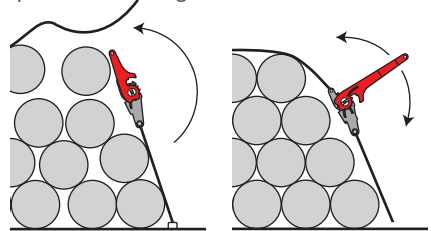

Safety label on every strap

So that you can always check whether the ratchet strap is suitable for the load to be secured; each strap is equipped with a label that describes safe WLL. The strap may not be used without this label. Our tension ratchets combine the greatest security with economy and efficiency. These ratchets make your everyday life easier and help you work faster which equals more profitability... What more could you want?



Ratchet Strap Assemblies

2" Ratchet Assemblies with Long, Wide Handle



LoadGard™ Yellow Standard Treated Webbing



End Fitting	Width	Length	WLL*	Part #
Flat Hook (FH)	2"	27 ft.	2,000 lbs.	6R27FHY
	2"	30 ft.	2,000 lbs.	6R30FHY
	2"	27 ft.	3,335 lbs.	10R27FHY
	2"	30 ft.	3,335 lbs.	10R30FHY
	2"	27 ft.	4,000 lbs.	12R27FHY
	2"	30 ft.	4,000 lbs.	12R30FHY
Delta Ring (DR)	2"	27 ft.	2,000 lbs.	6R27DRY
	2"	30 ft.	2,000 lbs.	6R30DRY
	2"	27 ft.	3,335 lbs.	10R27DRY
	2"	30 ft.	3,335 lbs.	10R30DRY
	2"	27 ft.	4,000 lbs.	12R27DRY
	2"	30 ft.	4,000 lbs.	12R30DRY
Chain & Grab Hook (CG)	2"	27 ft.	2,000 lbs.	6R27CGY
	2"	30 ft.	2,000 lbs.	6R27CGY
	2"	27 ft.	3,335 lbs.	10R27CGY
	2"	30 ft.	3,335 lbs.	10R30CGY
Triangle & Grab Hook (TH)	2"	27 ft.	3,335 lbs.	10R27THY
	2"	30 ft.	3,335 lbs.	10R30THY
J Hook	2"	27 ft.	2,000 lbs.	6R27JY
	2"	30 ft.	2,000 lbs.	6R30JY
	2"	27 ft.	3,335 lbs.	10R27JY
	2"	30 ft.	3,335 lbs.	10R30JY
	2"	27 ft.	4,000 lbs.	12R27JY
	2"	30 ft.	4,000 lbs.	12R30JY

*WLL=Working Load Limit

How to order wide handle ratchet strap assemblies

10	R	27	FH	Y*
Minimum Break in Thousand lbs.	Ratchet Assembly	Length in Feet	End Fitting	Color Code

*Note: Y denotes LoadGard™ Yellow Webbing – No color code denotes WearGard™ Orange PVC Webbing.

Replacement parts and other colors available.

See Corner Protectors on page 25.

For short narrow handle add "SH" to the part number. (Example: 10R27FHYSH)
 For short wide handle add "WH" to the part number. (Example: 10R27FHYWH)
 Longer lengths or specially made assemblies available. Call Customer Service at 1-800-334-7505.

Ratchet Strap Assemblies

2" Ratchet Assemblies with Long, Wide Handle



WearGard™ Orange Premium PVC Impregnated Webbing

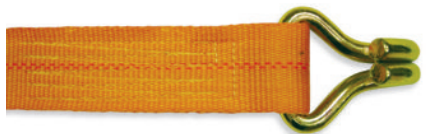

End Fitting	Width	Length	WLL*	Part #
Flat Hook (FH)	2"	27 ft.	2,000 lbs.	6R27FH
	2"	30 ft.	2,000 lbs.	6R30FH
	2"	27 ft.	3,335 lbs.	10R27FH
	2"	30 ft.	3,335 lbs.	10R30FH
	2"	27 ft.	4,000 lbs.	12R27FH
	2"	30 ft.	4,000 lbs.	12R30FH
Delta Ring (DR)	2"	27 ft.	2,000 lbs.	6R27DR
	2"	30 ft.	2,000 lbs.	6R30DR
	2"	27 ft.	3,335 lbs.	10R27DR
	2"	30 ft.	3,335 lbs.	10R30DR
	2"	27 ft.	4,000 lbs.	12R27DR
	2"	30 ft.	4,000 lbs.	12R30DR
Chain & Grab Hook (CG)	2"	27 ft.	2,000 lbs.	6R27CG
	2"	30 ft.	2,000 lbs.	6R27CG
	2"	27 ft.	3,335 lbs.	10R27CG
	2"	30 ft.	3,335 lbs.	10R30CG
Triangle & Grab Hook (TH)	2"	27 ft.	3,335 lbs.	10R27TH
	2"	30 ft.	3,335 lbs.	10R30TH
J Hook	2"	27 ft.	2,000 lbs.	6R27J
	2"	30 ft.	2,000 lbs.	6R30J
	2"	27 ft.	3,335 lbs.	10R27J
	2"	30 ft.	3,335 lbs.	10R30J
	2"	27 ft.	4,000 lbs.	12R27J
	2"	30 ft.	4,000 lbs.	12R30J

*WLL=Working Load Limit

See Corner Protectors on page 25.

For short narrow handle add "SH" to the part number. (Example: 10R27FHSH)
 For short wide handle add "WH" to the part number. (Example: 10R27FHWH)
 Longer lengths or specially made assemblies available. Call Customer Service at 1-800-334-7505.

How to order wide handle ratchet strap assemblies

10	R	27	FH	Y*
Minimum Break in Thousand lbs.	Ratchet Assembly	Length in Feet	End Fitting	Color Code

*Note: Y denotes LoadGard™ Yellow Webbing – No color code denotes WearGard™ Orange PVC Webbing.

Replacement parts available.

Ratchet Strap Assemblies

2" ABS™ Controlled Release Ratchet Tiedown System

with #1860 ABS™ Ratchet (Pat. nos. 5,103,536 & 5,205,020)



LoadGard™ Blue Standard Treated Webbing

SpanSet's ABS Controlled Release Ratchet Tiedown System gives the operator total control of the load both during load securement and release.

- Double latch ratchet system allows much higher pre-tension to be applied during initial load securement, allowing a fine adjustment for greater pre-tension.
- Dual control release system allows release of the pre-tension step by step, one "notch" at a time, to ensure stability of the load prior to final release.
- The patented ABS SpanSet Ratchet Tiedown System features a distinguishing blue epoxy finish for surface protection and a double locking mechanism for load transport security.

End Fitting	Length	WLL*	Part #
Flat Hook (FH)	27 ft.	2,000 lbs.	6RA27FHB
	27 ft.	3,335 lbs.	10RA27FHB
Delta Ring (DR)	27 ft.	2,000 lbs.	6RA27DRB
	27 ft.	3,335 lbs.	10RA27DRB
Chain & Grab Hook (CG)	27 ft.	3,335 lbs.	10RA27CGB
	27 ft.	3,335 lbs.	10RA27THB

3" Ratchet Assemblies – Extra Heavy Duty



LoadGard™ Yellow Standard Treated Webbing

Flat Hook (FH) Delta Ring (DR) Chain & Grab Hook (CG) Triangle & Grab Hook (TH) J Hook



End Fitting	Width	Length	WLL*	Part #
Flat Hook (FH)	3"	27 ft.	5,000 lbs.	15R27FHY
	3"	30 ft.	5,000 lbs.	15R30FHY
Delta Ring (DR)	3"	27 ft.	5,000 lbs.	15R27DRY
	3"	30 ft.	5,000 lbs.	15R30DRY
Chain & Grab Hook (CG)	3"	27 ft.	5,000 lbs.	15R27CGY
	3"	30 ft.	5,000 lbs.	15R30CGY
Triangle & Grab Hook (TH)	3"	27 ft.	5,000 lbs.	15R27THY
	3"	30 ft.	5,000 lbs.	15R30THY
J Hook	3"	27 ft.	5,000 lbs.	15R27JY
	3"	30 ft.	5,000 lbs.	15R30JY

*WLL=Working Load Limit

Ratchet Strap Assemblies

WearGard™ Orange Premium PVC Impregnated Webbing

End Fitting	Width	Length	WLL*	Part #
Flat Hook (FH)	3"	27 ft.	5,000 lbs.	15R27FH
	3"	30 ft.	5,000 lbs.	15R30FH
Delta Ring (DR)	3"	27 ft.	5,000 lbs.	15R27DR
	3"	30 ft.	5,000 lbs.	15R30DR
Chain & Grab Hook (CG)	3"	27 ft.	5,000 lbs.	15R27CG
	3"	30 ft.	5,000 lbs.	15R30CG
Triangle & Grab Hook (TH)	3"	27 ft.	5,000 lbs.	15R27TH
	3"	30 ft.	5,000 lbs.	15R30TH
J Hook	3"	27 ft.	5,000 lbs.	15R27J
	3"	30 ft.	5,000 lbs.	15R30J

*WLL=Working Load Limit

4" Ratchet Assemblies – Extra Heavy Duty



LoadGard™ Yellow Standard Treated Webbing

End Fitting	Width	Length	WLL*	Part #
Flat Hook (FH)	4"	27 ft.	5,400 lbs.	16R27FHY
	4"	30 ft.	5,400 lbs.	16R30FHY
Delta Ring (DR)	4"	27 ft.	5,400 lbs.	16R27DRY
	4"	30 ft.	5,400 lbs.	16R30DRY
Chain & Grab Hook (CG)	4"	27 ft.	5,000 lbs.	16R27CGY
	4"	30 ft.	5,000 lbs.	16R30CGY
Triangle & Grab Hook (TH)	4"	27 ft.	5,000 lbs.	16R27THY
	4"	30 ft.	5,000 lbs.	16R30THY
J Hook	4"	27 ft.	5,400 lbs.	16R27JY
	4"	30 ft.	5,400 lbs.	16R30JY

WearGard™ Orange Premium PVC Impregnated Webbing

End Fitting	Width	Length	WLL*	Part #
Flat Hook (FH)	4"	27 ft.	5,400 lbs.	16R27FH
	4"	30 ft.	5,400 lbs.	16R30FH
Delta Ring (DR)	4"	27 ft.	5,400 lbs.	16R27DR
	4"	30 ft.	5,400 lbs.	16R30DR
Chain & Grab Hook (CG)	4"	27 ft.	5,000 lbs.	16R27CG
	4"	30 ft.	5,000 lbs.	16R30CG
Triangle & Grab Hook (TH)	4"	27 ft.	5,000 lbs.	16R27TH
	4"	30 ft.	5,000 lbs.	16R30TH
J Hook	4"	27 ft.	5,400 lbs.	16R27J
	4"	30 ft.	5,400 lbs.	16R30J

See Corner Protectors on page 25. Special assemblies available upon request. Replacement Parts Available.

*WLL=Working Load Limit

03.2





Winch Strap Assemblies

LoadGard™

Winch Strap Assemblies

WearGard™

Winch Strap Assemblies

Trailer Winches, Winch Bars & Accessories

Winch Strap Assemblies

LoadGard™ Yellow Standard Treated Webbing

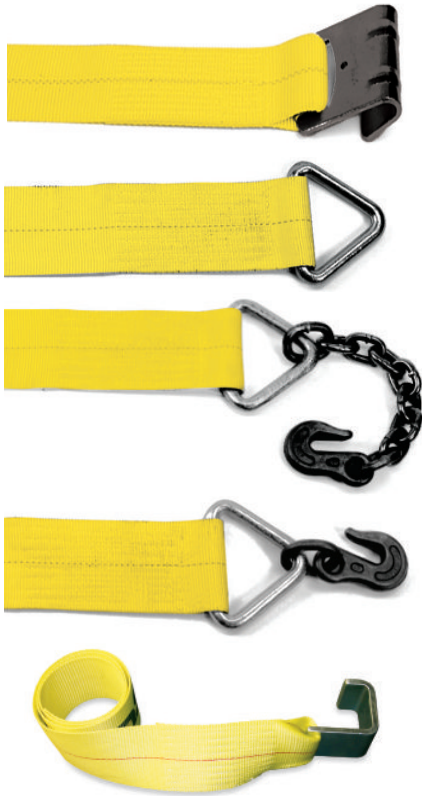

End Fitting	Width	Length	WLL*	Part #
Flat Hook (FH)	2"	27 ft.	3,335 lbs.	WS227FHY
	2"	30 ft.	3,335 lbs.	WS230FHY
	3"	27 ft.	4,335 lbs.	WS327FHY
	3"	30 ft.	4,335 lbs.	WS330FHY
	4"	27 ft.	5,400 lbs.	WS427FHY
	4"	30 ft.	5,400 lbs.	WS430FHY
Delta Ring (DR)	2"	20 ft.	3,335 lbs.	WS220DRY
	2"	27 ft.	3,335 lbs.	WS227DRY
	3"	27 ft.	4,335 lbs.	WS327DRY
	3"	30 ft.	4,335 lbs.	WS330DRY
	4"	27 ft.	5,400 lbs.	WS427DRY
	4"	30 ft.	5,400 lbs.	WS430DRY
Chain & Grab Hook (CG)	3"	27 ft.	4,335 lbs.	WS327CGY
	3"	30 ft.	4,335 lbs.	WS330CGY
	4"	27 ft.	5,000 lbs.	WS427CGY
	4"	30 ft.	5,000 lbs.	WS430CGY
Triangle & Grab Hook (TH)	4"	27 ft.	5,000 lbs.	WS427THY
	4"	30 ft.	5,000 lbs.	WS430THY
Looped End (LE)	4"	30 ft.	5,335 lbs.	WS430LEY
Roll On/ Roll Off Container Strap	4"	5 ft.	5335 lbs.	WS405TCSY

WearGard™ Orange Premium PVC Impregnated Webbing



End Fitting	Width	Length	WLL*	Part #
Flat Hook (FH)	2"	27 ft.	3,335 lbs.	WS227FH
	2"	30 ft.	3,335 lbs.	WS230FH
	3"	27 ft.	4,335 lbs.	WS327FH
	3"	30 ft.	4,335 lbs.	WS330FH
	4"	27 ft.	5,400 lbs.	WS427FH
	4"	30 ft.	5,400 lbs.	WS430FH
Delta Ring (DR)	2"	20 ft.	3,335 lbs.	WS220DR
	2"	27 ft.	3,335 lbs.	WS227DR
	3"	27 ft.	4,335 lbs.	WS327DR
	3"	30 ft.	4,335 lbs.	WS330DR
	4"	27 ft.	5,400 lbs.	WS427DR
	4"	30 ft.	5,400 lbs.	WS430DR
Chain & Grab Hook (CG)	3"	27 ft.	4,335 lbs.	WS327CG
	3"	30 ft.	4,335 lbs.	WS330CG
	4"	27 ft.	5,000 lbs.	WS427CG
	4"	30 ft.	5,000 lbs.	WS430CG
Triangle & Grab Hook (TH)	4"	27 ft.	5,000 lbs.	WS427TH
	4"	30 ft.	5,000 lbs.	WS430TH
Looped End (LE)	4"	30 ft.	5,335 lbs.	WS430LE

*WLL=Working Load Limit

Note: Longer or shorter lengths are available on all webbing assemblies.

See Corner Protectors on page 25.

SpanSet

WardGuard™ PVC
Made in USA

SpanSet®

LOAD CONTROL SYSTEMS
SANFORD, N.C. 27332-6068

SpanSet

WardGuard™ PVC
Made in USA

SpanSet
LOAD CONTROL SYSTEMS
SANFORD, N.C.

Trailer Winches

SpanSet Heavy Duty Trailer Winches are designed for rugged use, making SpanSet winches excellent choices for the heavy-duty transportation industry.

Winches/Heavy Duty Trailer

Weld-On Webbing Winches Fixed Position, Permanently Mounted



8110

- Standard weld-on fixed bottom mount winch
- Fully slotted mandrel
- Designed for use with 3" and 4" webbing
- Holds approx. 30 ft. of webbing

Portable Webbing Winches Flexible Mounting on Side Channel



8120

- Standard portable mount winch using 2 set screws
- Fully slotted mandrel
- Designed for use with 3" and 4" webbing
- Holds approx. 30 ft. of webbing

Caution: Do not over tighten bolts. This will bend the bracket and may cause the winch to fail.

Spool Type/Weld-On Webbing Winches Fixed Mount



8212

- Fully slotted mandrel
- Designed for use with 2" webbing
- Holds approx. 40 ft. of webbing
- Side plates for webbing protection

For 3" webbing order part # 8213

Sliding Webbing Winches Slider Track or Fixed Mount



8150

- Low Profile notched frame winch
- Fully slotted mandrel
- May be used as weld-on
- Holds approx. 20 ft. of webbing when used as slider



8214

- Fully slotted mandrel
- Designed for use with 4" webbing
- Holds approx. 40 ft. of webbing
- Side plates for webbing protection



8250

- High Profile notched frame winch
- Fully slotted mandrel
- Holds approx. 30 ft. of webbing

May also be used as deep storable weld-on (part # 8210 – no notches)

Warning!

When using a winch bar an extension (cheater) bar must not be used, severe injury can occur.

Winch Accessories

Web Strap Winder



6231

- Steel with zinc plating
- 2" - 4" strap
- Easily dismantled

Weld-On Slider Winch Track

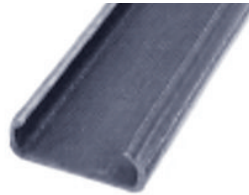

6112

- Standard 6 ft. length
- Heavy gauge steel
- Use with part #s 8150 and 8250 sliding winches

Winch Bars

6341



- Winch adjusting bar with offset tip and knurled non-slip handle
- Length 33"
- Black painted

6351



- Winch adjusting bar with offset tip and knurled non-slip handle
- Length 33"
- Chrome type finish

6361



- Winch adjusting bar with offset tip and knurled non-slip handle
- Chrome type finish
- Modified handle for tightening chain binders

Winch Specifications

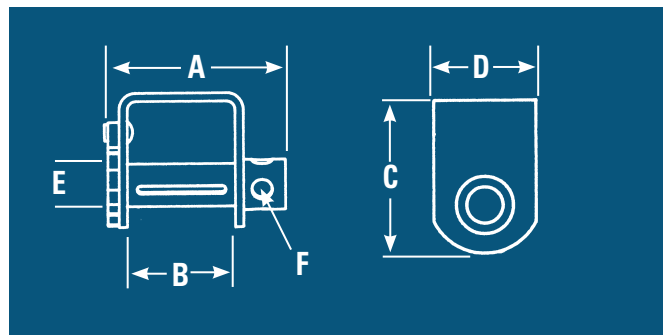

Item Dimensions in Inches

	A	B	C	D	E	F
8110	7 ³ / ₄	4 ⁷ / ₈	6 ¹ / ₄	3 ⁷ / ₈	1 ⁷ / ₈	15/16
8120	7 ³ / ₄	4 ⁷ / ₈	6 ¹ / ₄	3 ¹ / ₂	1 ⁷ / ₈	15/16
8150	7 ³ / ₄	4 ³ / ₄	5 ¹ / ₂	4	1 ⁷ / ₈	15/16
8210	7 ³ / ₄	4 ⁷ / ₈	7 ¹ / ₂	3 ⁷ / ₈	1 ⁷ / ₈	15/16
8212	6 ¹ / ₄	3 ³ / ₈	6 ³ / ₈	3 ¹ / ₂	1 ⁷ / ₈	15/16
8213	6 ³ / ₈	3 ³ / ₄	6 ¹ / ₄	3 ¹ / ₂	1 ⁷ / ₈	15/16
8214	7 ⁷ / ₈	4 ⁷ / ₈	6 ¹ / ₄	3 ¹ / ₂	1 ⁷ / ₈	15/16
8250	7 ³ / ₄	4 ⁷ / ₈	7 ¹ / ₂	3 ⁷ / ₈	1 ⁷ / ₈	15/16

Note: Dimensions of some winches may differ slightly.

Warning!

When using a winch bar an extension (cheater) bar must not be used, severe injury can occur.

03.3





Accessories

Internal Load Control Products

Internal Van Straps
SpanLoc™ Cargo Bars
Logistics Track
Decking/Shoring Beams
Wood Beam Socket

Vehicle Recovery

Automobile Tiedowns
Wheel Bonnets
Cargo Nets

Tiedown Accessories

Chains and Binders
Rubber Tarp Straps
Corner Protectors
Stake Pocket Anchors

Internal Load Control Products

Internal Van Straps

SpanSet's internal van tiedowns are designed with spring loaded E-Clips for use with all standard E-Track or A-Track. Fittings for F-Track are available upon request. SpanSet's premium grade internal van tiedowns use 2" wide webbing. They are color coded to length for quick and easy identification.

Cam Buckle #SS203 3000 lb. MBS Capacity – 2" Wide



Length	Webbing Color	End Fitting	WLL*	Part #
12 ft.	Yellow	E-Clip (#1265)	1,000 lbs.	V30CB12EC
12 ft.	Yellow	3 Piece E-Clip (#1826)	1,000 lbs.	V30CB12EC3
12 ft.	Yellow	F-Clip (#1245)	500 lbs.	V30CB12FC
16 ft.	Grey	E-Clip (#1265)	1,000 lbs.	V30CB16EC
16 ft.	Grey	3 Piece E-Clip (#1826)	1,000 lbs.	V30CB16EC3
16 ft.	Grey	F-Clip (#1245)	500 lbs.	V30CB16FC
20 ft.	Blue	E-Clip (#1265)	1,000 lbs.	V30CB20EC
20 ft.	Blue	3 Piece E-Clip (#1826)	1,000 lbs.	V30CB20EC3
20 ft.	Blue	F-Clip (#1245)	500 lbs.	V30CB20FC

Note: Webbing color denotes length.

Ratchet Buckle #1803 4000 lb. MBS Capacity – 2" Wide

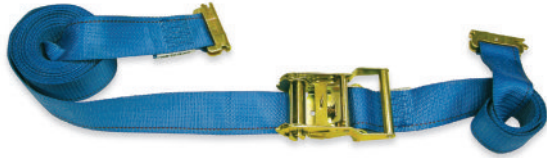

Length	Webbing Color	End Fitting	WLL*	Part #
12 ft.	Yellow	E-Clip (#1265)	1,000 lbs.	V50R12EC
12 ft.	Yellow	3 Piece E-Clip (#1826)	1,000 lbs.	V50R12EC3
12 ft.	Yellow	F-Clip (#1245)	500 lbs.	V50R12FC
16 ft.	Grey	E-Clip (#1265)	1,000 lbs.	V50R16EC
16 ft.	Grey	3 Piece E-Clip (#1826)	1,000 lbs.	V50R16EC3
16 ft.	Grey	F-Clip (#1245)	500 lbs.	V50R16FC
20 ft.	Blue	E-Clip (#1265)	1,000 lbs.	V50R20EC
20 ft.	Blue	3 Piece E-Clip (#1826)	1,000 lbs.	V50R20EC3
20 ft.	Blue	F-Clip (#1245)	500 lbs.	V50R20FC

Note: Webbing color denotes length.

Rope Tie-off

3,000 lbs. with D-Ring and E-Clip
Designed for use with E- or A-Track.
Standard Length 6".



Length	End Fitting	Part #
6"	E-Clip (#1265) D-Ring (#4068)	V30RTOEC
6"	3 Piece E Clip (1825) & D-Ring (#4068)	V30RTOEC-3
6"	F-Clip (#1245) & D-Ring (#4068)	V30RTOFC

Cargo Bars

SpanLoc™ Cargo Bar – Heavy Duty Steel



- Universal – fits both 96" and 102" trailers
- Made from heat treated construction grade steel
- Scuff resistant – high traction feet
- Easy to operate thumb latch and handle
- Easy maintenance – feet, rack, and housing use nuts, bolts, and set screws for quick parts replacement
- Universal Steel Cargo Bar, Part#CB89104S

*Also available in aluminum: Part # CB89104

SpanLoc™ Jack-Style Cargo Bars



Square Heavy Duty

- Adjustable from 86" to 109"
- Heavy duty steel tubing
- Scuff and slip resistant rubber feet
- Jack-style handle permits quick placement
- Square/Heavy Duty style, Part #14101

Logistics Track – Series E



HET-10

- 10 ft. Horizontal

Note: High strength 12 gauge steel.
Strength: 50,000 lbs. min. yield



VET-10

- 10 ft. Vertical

Note: High strength 11 gauge steel.
Strength: 50,000 lbs. min. yield

Decking/Shoring Beams



- Fits "E" and "A" Logistics Tracks
- Made from heat treated construction grade aluminum
- 2,000 lbs. capacity as decking support*
- 2,000 lbs. capacity as shoring support*
- All steel end channels with wide adjustment range
- Available in adjustment lengths of 92" to 103"

Fits	Part #	Replacement	Part#
96" Trailer	DS8495	Attaching Pin	AP1
		Decking Beam Repair Kit	DBRK
96" & 102" Trailers	DS92103	Attaching Pin	AP1
		Decking Beam Repair Kit	DBRK

*Working Load Capacities based on evenly distributed loads.

Wood Beam Socket

WBS1



- Heavy duty
- Designed for use with 2" x 4" or 2" x 6" lumber
- Spring loaded clip fits both "E" and "A" Series Logistic Track

Note: Working Load Capacities in different grades of lumber vary widely.

Door Pull Strap

With Galvanized Prepunched Clip



Length	Part #
15"	DPS15
18"	DPS18
24"	DPS24

Vehicle Recovery

Automobile Tiedowns

Flat Trailers



Description	Width	Length	Part#
1. Axle Strap (w/ D-rings) & Protective Sleeve	2"	2 ft.	AS2
	2"	3 ft.	AS3
2. Wheel Tie-back (w/1215 Twisted Snap Hook)	2"	4 ft.	WTB4
	2"	6 ft.	WTB6
3. Combination Ratchet Strap (w/1215 Twisted Snap Hook and 1857 Ratchet)	2"	6 ft.	CRS6
	2"	8 ft.	CRS8
4. Ratchet Wheel Strap	2"	6 ft.	RWS6
	2"	8 ft.	RWS8
5. Protective Sleeve for Axle Strap (shown with axle strap)	2"	18"	PS1

Wheel Bonnet



Description	Tire Size	Part#
Standard Wheel Bonnet	16"	WTD16716
Standard Wheel Bonnet	17"	WTD16717
Standard Wheel Bonnet	18"	WTD16718
Adjustable Wheel Bonnet	13"-15"	WTD170Y

Interior Van Custom Nets

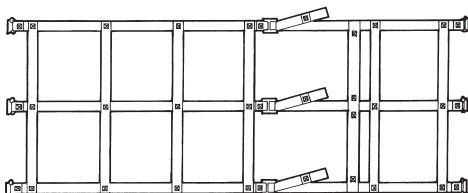

SpanSet Interior Van Nets are custom made for your particular application. They offer excellent support for various size and shaped packages. Standard end fittings fit "E" or "A" track. Tensioning buckles can be either "Cam" or "Ratchet" type. Because they are individually designed for particular applications, SpanSet nets offer maximum effectiveness in transporting a load securely. Call SpanSet Customer Service with your special requirements.

Chain and Chain Binders

Ratchet Chain Binders Lever Chain Binders



Description	Size	WLL	Part#
Level Chain Binder (Import)	5/16"-3/8"	5,400 lbs.	190111
Ratchet Style Chain Binder (Import)	5/16"-3/8"	5,400 lbs.	190121

Black EPDM Rubber Tarp Straps



Description	Length	Part#
All rubber tarp straps come assembled with S-hooks attached. Straps are designed to hold tarps securely in place, not to hold loads in place. Packaged 50 per box.	9"	RTS09
	15"	RTS15
	21"	RTS21
	31"	RTS31
	41"	RTS41

Warning! Extreme caution must be taken when using rubber tarp straps. Wear safety goggles while stretching or disconnecting. Stretching beyond 1/2 of the original length can cause strap to break, resulting in serious injury.

Corner Protectors

Corner protectors are designed to protect cargo and straps. Rubber protectors conform to the load. Plastic protectors have a protective corner recess and are molded to 90°.



CP102/CP104
Reinforced Rubber

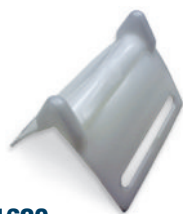

1620
Molded Plastic



SF12
Secutex® Sleeve



1234
Nylon Sleeve

Web Width	Length	Part#
2"	12" Reinforced Rubber	CP102
4"	12" Reinforced Rubber	CP104
2",3" & 4"	4" Molded Plastic Protector	1620
2"	2" Nylon Sleeve	1234
2"	2" Secutex® Sleeve	SF12
3"	3" Secutex® Sleeve	SF13
4"	4" Secutex® Sleeve	SF14

Stake Pocket Anchors

Fits most full sized pickup trucks



Quantity	Part#
2 per bag	SPA2
20 Bulk Box	SPA20

03.4





Utility Tiedowns

- 1" Ratchet Buckle Assemblies
- 1 3/8" Ratchet Buckle Assemblies
- 2" Ratchet Buckle Assemblies
- 1" Cam Buckle Assemblies

Utility Tiedowns

Utility rated tiedowns are designed for farm, automotive, utility, marine, light truck and industrial uses. SpanSet offers a wide variety of webbing, end fittings and tensioning devices that cover most any requirement. All SpanSet Utility Rated Tiedown Straps are packaged for individual counter sales with the UPC label.



J-Hooks – designed for greatest strength. Capable of grabbing bars up to 1" in diameter.



J-Hook and Keeper Rings – allow use of the hook only or with keeper ring, will fit most any size object you wish to use as an anchor point. Most versatile end fitting.



S-Hooks – vinyl coated to protect finished surfaces such as: motorcycles, snowmobiles, and have a large radius to hook onto handlebars.



Forged Snap Hook – forged steel with safety latch.



Flat Snap Hook – flat stamped steel with safety latch.



Endless – No Fitting.

Ratchet Buckle Assemblies

1" Ratchet Buckle Assembly

Rated in Straight Pull Capacity w/ #1800 Ratchet and 2,500 lb. Webbing



1" Ratchet Buckle Assembly

Rated in Straight Pull Capacity w/ #1801 Ratchet and 4,000 lb. Webbing



End Fitting	Width	Length	Capacity	Part#
J Hook & Keeper (JK)	1"	12 ft.	1,500 lbs.	30R12JK
	1"	15 ft.	1,500 lbs.	20R15JK
	1"	20 ft.	1,500 lbs.	30R20JK
S-Hook (S)	1"	12 ft.	1,500 lbs.	30R12S
	1"	15 ft.	1,500 lbs.	*30R15S
	1"	20 ft.	1,500 lbs.	*30R20S
Snap Hook (SP)	1"	12 ft.	1,500 lbs.	30R12SP
	1"	15 ft.	1,500 lbs.	30R15SP
	1"	20 ft.	1,500 lbs.	30R20SP
Endless (E) (No End Fitting)	1"	12 ft.	1,500 lbs.	30R12E
	1"	15 ft.	1,500 lbs.	30R15E
	1"	20 ft.	1,500 lbs.	30R20E

End Fitting	Width	Length	Capacity	Part#
J Hook & Keeper (JK)	1"	15 ft.	3,000 lbs.	*40R15JK
	1"	20 ft.	3,000 lbs.	*40R20JK
J Hook (J)	1"	15 ft.	3,000 lbs.	*40R15J
	1"	20 ft.	3,000 lbs.	40R20J
Flat Snap Hook (FSH)	1"	15 ft.	3,000 lbs.	40R15FSH
	1"	20 ft.	3,000 lbs.	40R20FSH
Endless (E) (No End Fitting)	1"	15 ft.	3,000 lbs.	40R15S
	1"	20 ft.	3,000 lbs.	40R20S
S-Hook (S)	1"	15 ft.	2,000 lbs.	40R15S
	1"	20 ft.	2,000 lbs.	50R20S



*Ratchet and Cam Buckle Assemblies are packaged in a sturdy clamshell for optimum display value, anti-pilferage security, and the best space usage.

Utility Tiedowns

1 3/8" Ratchet Buckle Assembly

Rated in Straight Pull Capacity w/ #1804 Ratchet and 5,500 lb. Webbing



End Fitting	Width	Length	Capacity	Part#
J Hook (J)	1 3/8"	15 ft.	4,000 lbs.	80R15J
	1 3/8"	20 ft.	1,500 lbs.	80R20J
Forged Snap Hook (SP)	1 3/8"	15 ft.	4,000 lbs.	*80R15SP
	1 3/8"	20 ft.	4,000 lbs.	80R20SP
Endless (E) (No End Fitting)	1 3/8"	15 ft.	4,000 lbs.	80R15E
	1 3/8"	20 ft.	4,000 lbs.	80R20E

2" Ratchet Buckle Assembly

Rated in Straight Pull Capacity w/ #1803 Ratchet and 5,500 lb. Webbing



End Fitting	Width	Length	Capacity	Part#
J Hook & Keeper (JK)	2"	12 ft.	3,000 lbs.	60R12JK
	2"	20 ft.	3,000 lbs.	60R20JK
J- Hook (J)	2"	12 ft.	3,000 lbs.	*60R12J
	2"	20 ft.	3,000 lbs.	*60R20J
Forged Snap Hook (SP)	2"	12 ft.	3,000 lbs.	60R12SP
	2"	20 ft.	3,000 lbs.	60R20SP
Endless (E) (No End Fitting)	2"	12 ft.	3,000 lbs.	60R12E
	2"	20 ft.	3,000 lbs.	60R20E

Cam Buckle Assemblies

Cam Buckle Assemblies have a capacity of up to 1,000 lbs. They are excellent for tying down bicycles, motorcycles, boats, snowmobiles, and many other items. Extremely easy to use, they are a rugged and inexpensive tiedown strap.

1" Cam Buckle Assembly

Rated in Straight Pull Capacity w/ #1152 Cam Buckle and 2,500 lb. or 4,000 lb. Webbing



End Fitting	Width	Length	Capacity	2500# Web. Part#	4000# Web. Part#
J Hook & Keeper (JK)	1"	9 ft.	1,000 lbs.	20B9JK	25B9JK
	1"	12 ft.	1,000 lbs.	20B12JK	25B12JK
	1"	20 ft.	1,000 lbs.	20B20JK	25B20JK
Forged Snap Hook (SP)	1"	5 ft.	1,000 lbs.	*20B5S	25B5S
	1"	12 ft.	1,000 lbs.	*20B12S	25B12S
	1"	20 ft.	1,000 lbs.	20B20S	25B20S
Endless (E) (No End Fitting)	1"	12 ft.	1,000 lbs.	20B12E	25B12E
	1"	20 ft.	1,000 lbs.	20B20E	25B20E



*Ratchet and Cam Buckle Assemblies are packaged in a sturdy clamshell for optimum display value, anti-pilferage security, and the best space usage.

Tow Straps

Tow Straps — Polyester

SpanSet Tow Straps are made of the finest quality polyester webbing. The webbing is designed to stretch, allowing a “shock absorbing” action which reduces shock loads that could damage vehicles or equipment. A special chemical treatment prevents mildew, dry-rot, and resists abrasion. Wear protection standard on both eyes.



Width	Length	Capacity	Part#
2"	15 ft.	6,000 lbs.	TS615
2"	20 ft.	6,000 lbs.	TS620
2"	24 ft.	6,000 lbs.	TS624
2"	15 ft.	12,000 lbs.	TS1215
2"	20 ft.	12,000 lbs.	TS1220
2"	25 ft.	12,000 lbs.	TS1225
3"	20 ft.	18,000 lbs.	TS1820
3"	24 ft.	18,000 lbs.	TS1824
3"	24 ft.	24,000 lbs.	TS2424
3"	30 ft.	24,000 lbs.	TS2430
2"	15 ft.	10,000 lbs.	TS1015H*
2"	25 ft.	12,000 lbs.	TS1225H*

* With forged hooks.

Heavy Duty Recovery/Tow Straps – Polyester and Nylon

SpanSet Recovery/Tow Straps are made of high tenacity polyester or nylon material and are available up to 180,000 lbs. on special request. Standard sizes listed here.



Width	Length	MBS	End Type	Part#	Part#
4"	24 ft.	32,000 lbs.	Sewn Eye	RS3224	RS3224N
4"	30 ft.	32,000 lbs.	Sewn Eye	RS3230	RS3230N
6"	24 ft.	48,000 lbs.	Sewn Eye	RS4824	RS4824N
6"	30 ft.	48,000 lbs.	Sewn Eye	RS4830	RS8230N
6"	30 ft.	82,000 lbs.	Sewn Eye	RS8230	RS8230N
6"	50 ft.	82,000 lbs.	Sewn Eye	RS8250	RS8250N

All Load Securing and Tow/Recovery Straps are Not the Same

Most anyone with a sewing machine can fabricate these products but that doesn't mean they are manufactured to industry standards and are safe to use. You must be sure these products have been properly designed, tested, rated and tagged. Your safe use of these products and the safety of others depend on it.

It is the owner's/user's responsibility to evaluate the suitability of any product in this catalog for their particular application. All products shown in this catalog are to be used for their intended use only. None of the products shown are to be used in a lifting application.

SpanSet Heavy Duty Tie Down products meet or exceed the requirements of the Web Sling and Tie Down Association (WSTDA) recommended Standard Specification for Synthetic Web Tie Downs WSTDA-T1.

Removal from service

A Tie Down should be removed from service if any of the following are visible:

- Holes, tears, cuts, snags or embedded particles in the webbing
- Broken or worn stitching in load bearing stitch patterns
- Excessive abrasive wear on the webbing
- Knots in any part of the webbing
- Distortion, excessive pitting, corrosion or damage of any fitting or component.
- Melting, charring or weld spatter on any part of the webbing
- Chemical burns
- Any condition which causes doubt as to the strength of the Tie Down

IMPORTANT!

Synthetic Web Tie Downs and Tow/Recovery Straps should be inspected by the person handling them each time they are used. Frequent visual inspection is your best safeguard. Contact SpanSet for further information on Inspection, Care and Use of Synthetic Web Tie Downs.

Fall Protection



Lifting

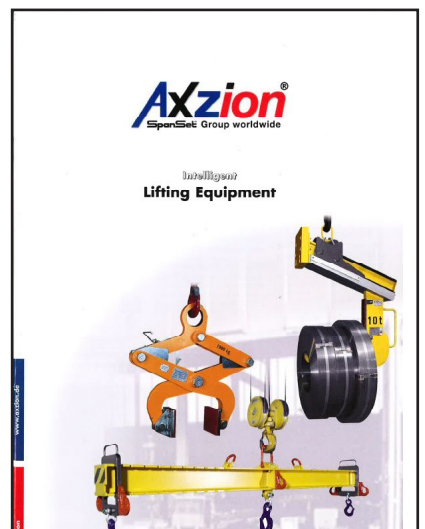
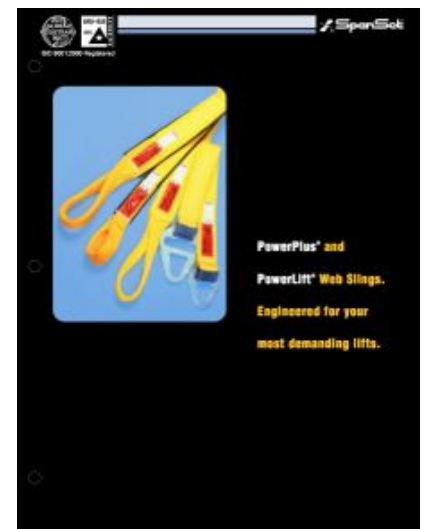
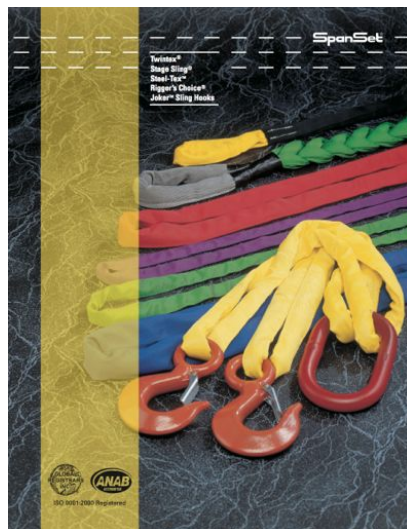

SpanSet has been an industry leader in lifting and cargo control products for over 30 years. SpanSet's quality control, with ISO 9001:2008 certified registration, and testing capabilities ensure that a quality product is produced with safety in mind.

SpanSet Inc.
3125 Industrial Dr.
Sanford, NC 27332
Phone: 800/334-7505
Fax: 919/774-7589
www.spanset-usa.com

Warranty

SpanSet, Inc. agrees (at its option) to repair, replace or credit the cost of any product which it has manufactured and which is found to be defective in materials or workmanship provided that written notice of such defect is received by SpanSet, Inc. within 90 days from the date of shipment. SpanSet will accept return of its products only upon its prior written authorization after receiving such notice. No authorization or allowance for repairs or alterations of any product will be given by SpanSet except by its written acknowledgment. Items not manufactured by SpanSet, Inc. will carry their manufacturer's warranties and none other.

The foregoing is in lieu of all warranties, expressed or implied, and all other obligations or liabilities on the part of SpanSet, including the warranties of merchantability and fitness. In no event shall SpanSet, Inc. be liable for consequential or special damages or for transportation, installation, adjustment or other expenses which may arise in connection with such products.